

# 447 MHz SAW Filter

# 162997

## Specifications

Parameter	Unit	Min	Typical	Max
Center Frequency ( $f_0$ )	MHz	-	447.0	-
Insertion Loss 440.0 ~ 454.0 MHz	dB	-	2.8	4.0
Ripple 440.0 ~ 454.0 MHz	dB	-	0.7	1.5
Stop Band Attenuation $f_0 - 200.0 \sim f_0 - 42.8$ MHz	dB	45	50	-
$f_0 - 42.8 \sim f_0 - 200.0$ MHz	dB	50	55	-
Terminating Impedance	$\Omega/pF$	50/0		

## Frequency Response

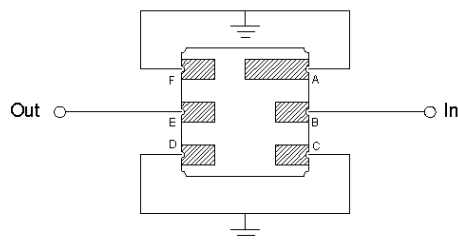
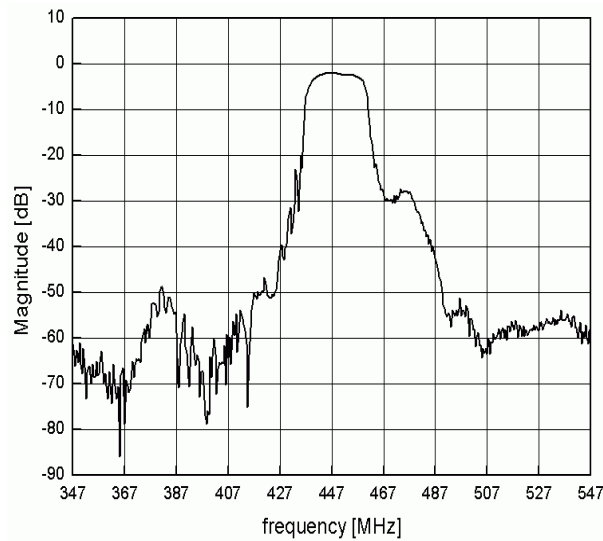

## Package Outline

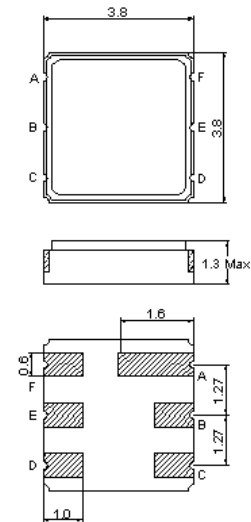

B: IN
E: Out
A,C,D,F: Ground

SAW PRODUCTS